

## RO - Spinner Type Straightener

Through feed spinner type Straightener.

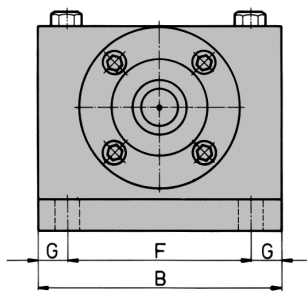
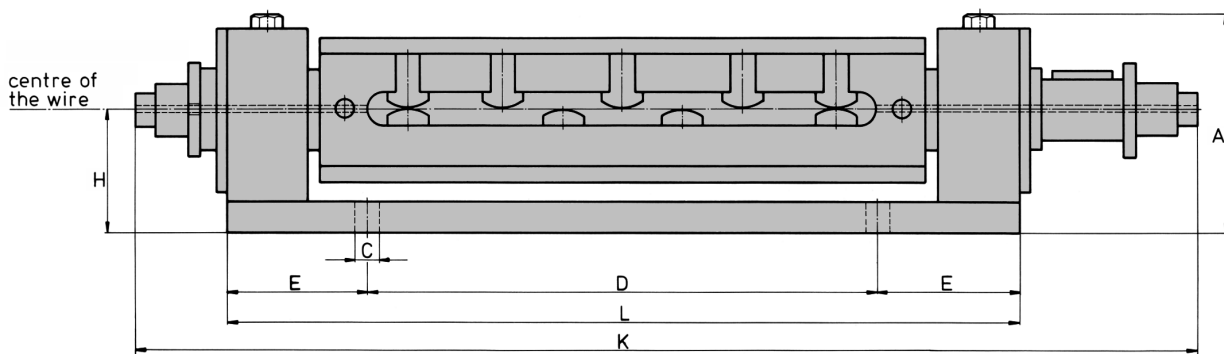

RO Series	Wire Diameter Ranges (mm) $\phi$			
	0.1 - 1.0	0.2 - 2.0	1.0 - 4.0	2.0 - 8.0
Order Ref.	RO7-1.0	RO5-2.0	RO3-4.0	RO3-8.0
A	80	110	140	153
B	80	120	140	150
C	9	11	13	13
D	117	248	220	326
E	50	71	80	90
F	58	94	108	120
G	11	13	16	15
H	42	60	75	80
K	322	519	518	655
L	217	390	380	506
Kg	8	25	38	49